



ARCTIC EXPEDITION

KNUD E. HANSEN DESIGN

145 MT EXPEDITION CRUISE VESSEL FOR THE ARCTIC

PAX
CRUISE
VESSELS



ARCTIC EXPEDITION

KNUD E. HANSEN DESIGN

145 MT EXPEDITION CRUISE VESSEL FOR THE ARCTIC

With the recent surge in eco-tourism and expedition travel in recent years, the cruise industry has ushered in a new type of consumer that represents a monumental shift from the stereotypical cruiser. Gone are the days where passengers seek only to bounce from one tropical island to the next while remaining blissfully unaware of the delicate nature of their environment or the carbon footprint they leave behind. This new demographic seeks to explore parts of the world that have remained relatively untouched, embracing the exquisite beauty of their natural surroundings without disturbing its habitat. While doing so, they wish to gain a greater understanding and appreciation for the natural world around them.

PUBLIC

PAX CABIN

PAX FLOW

CREW AREAS

TECHNICAL

CREW CABIN

In the fall of 2020 KNUD E. HANSEN showcased its latest design achievement: a 145m Ice breaking arctic expedition cruise vessel, with a capacity of 300Pax, and a range of 8100 nm in open water. The design boasts a dual fuel propulsion plant with marine diesel oil and LNG, a battery bank and podded propulsion.

The arrangement provides superior maneuverability and efficiency with the ability to provide zero emissions while moored in some of the worlds most environmentally sensitive regions. The design has a PC3 ice class and is equipped with all necessary facilities for arctic operations.

ARCTIC EXPEDITION

KNUD E. HANSEN DESIGN

145 MT EXPEDITION CRUISE VESSEL FOR THE ARCTIC

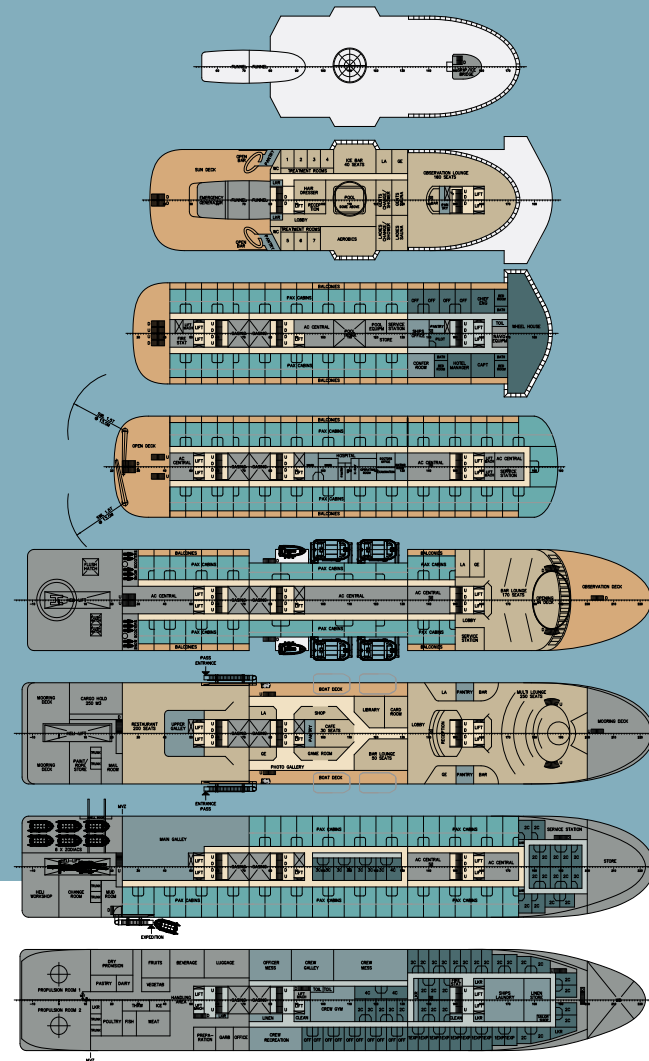
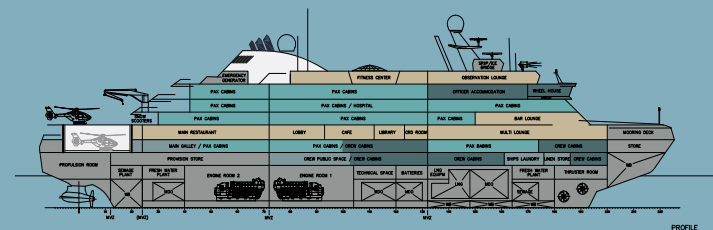



ARCTIC EXPEDITION

INTERIOR

MULTI LOUNGE DECK 5 & 6



ARCTIC EXPEDITION

INTERIOR

MULTI LOUNGE DECK 5 & 6



Today, KNUD E. HANSEN has expanded on this design by introducing a unique, interactive space on the vessel that encompasses elements of nature while offering passengers the opportunity to acquire a greater knowledge of their natural surroundings.

The space comprises two decks at the forward end of the vessel with the lower deck featuring a collection of artifacts and exhibits, multiple displays and informative touchscreens, a library, as well as interactive equipment including microscopes and a virtual reality experience. There is also a wraparound bar on centerline and lounge areas with comfortable seating throughout the space. Oversized porthole windows on both sides provide plenty of natural light while allowing passengers to enjoy magnificent views. Up forward is a convertible lecture hall with a stage and removeable partitions to allow for integration with the exhibit space.

The upper deck includes a smaller bar, science exhibits, lounge seating as well as full height, wraparound windows on the side and forward end of the superstructure which allow for stunning, panoramic views.

The space is outfitted with an ultra-modern décor that includes sustainable, natural wood finishes, adjustable LED lighting, and dimmable smart windows for optimal energy conservation. It provides passengers with an exceptional and unrivalled learning environment on the open seas with an equally comfortable place to relax and take in the beauty of their surroundings.

This design has been developed completely in-house, by the highly trained and experienced staff of naval architects, marine engineers and designers at KNUD E. HANSEN, who place the utmost importance on safety, efficiency and design ingenuity.

ARCTIC EXPEDITION

INTERIOR

MULTI LOUNGE DECK 5 & 6

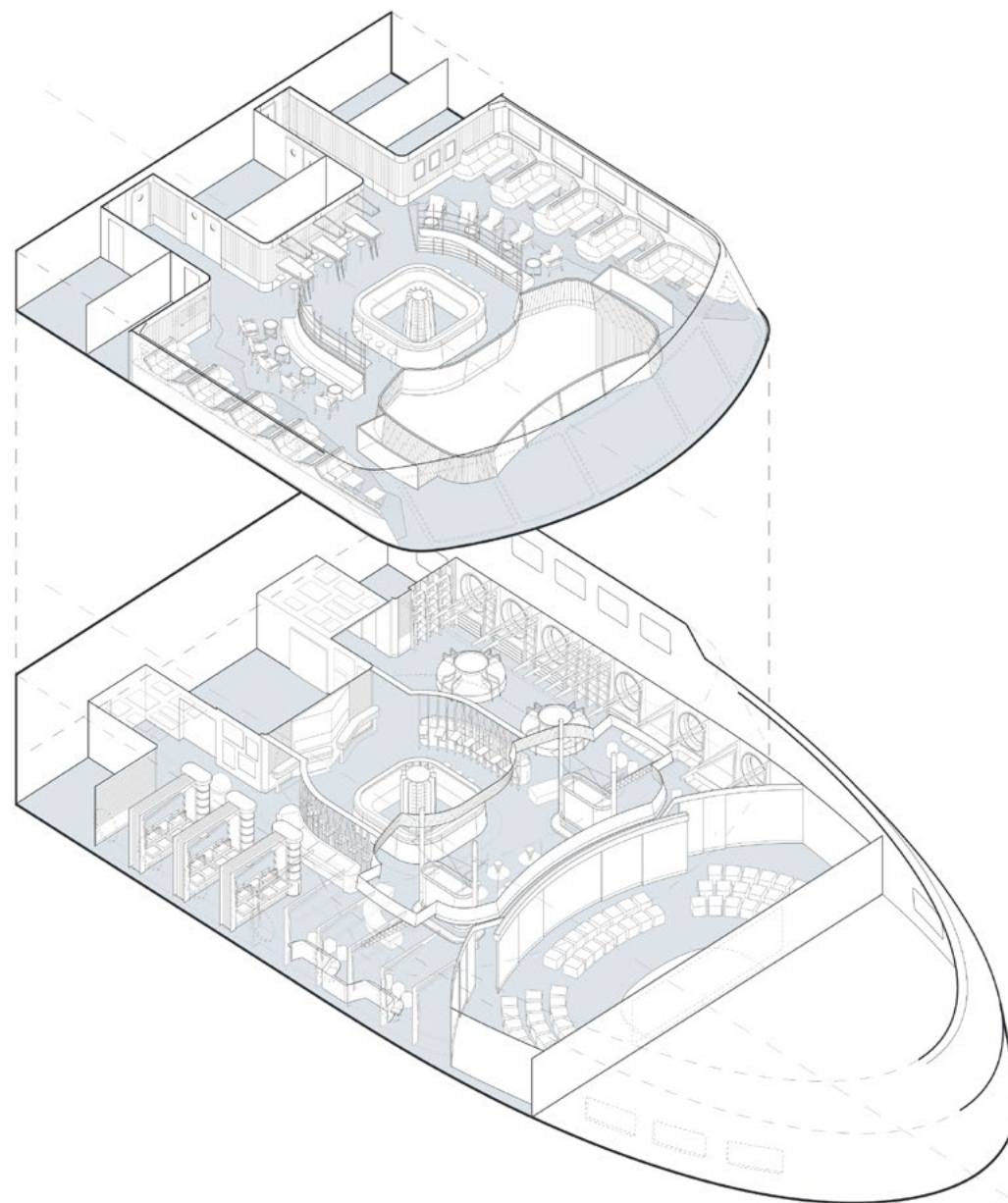

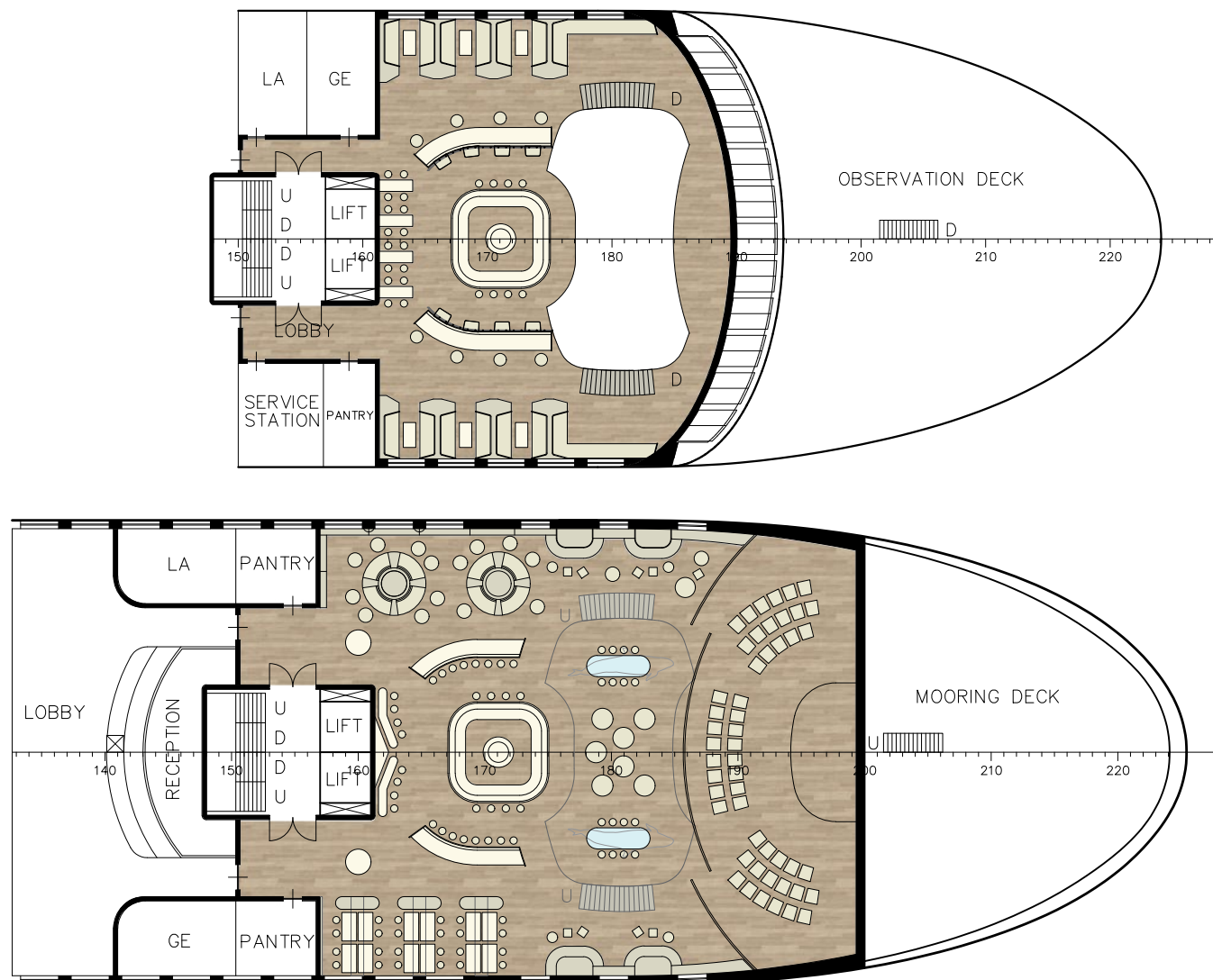

ARCTIC EXPEDITION

INTERIOR

MULTI LOUNGE DECK 5 & 6 • ATRIUM

Between the two decks is a large opening and stairwell on either side that creates a cavernous atrium, providing a bright, spacious feel typically found only on larger vessels.



ARCTIC EXPEDITION

INTERIOR

MULTI LOUNGE DECK 5 & 6 • ATRIUM



ARCTIC EXPEDITION

INTERIOR

MULTI LOUNGE DECK 5 & 6 • ATRIUM

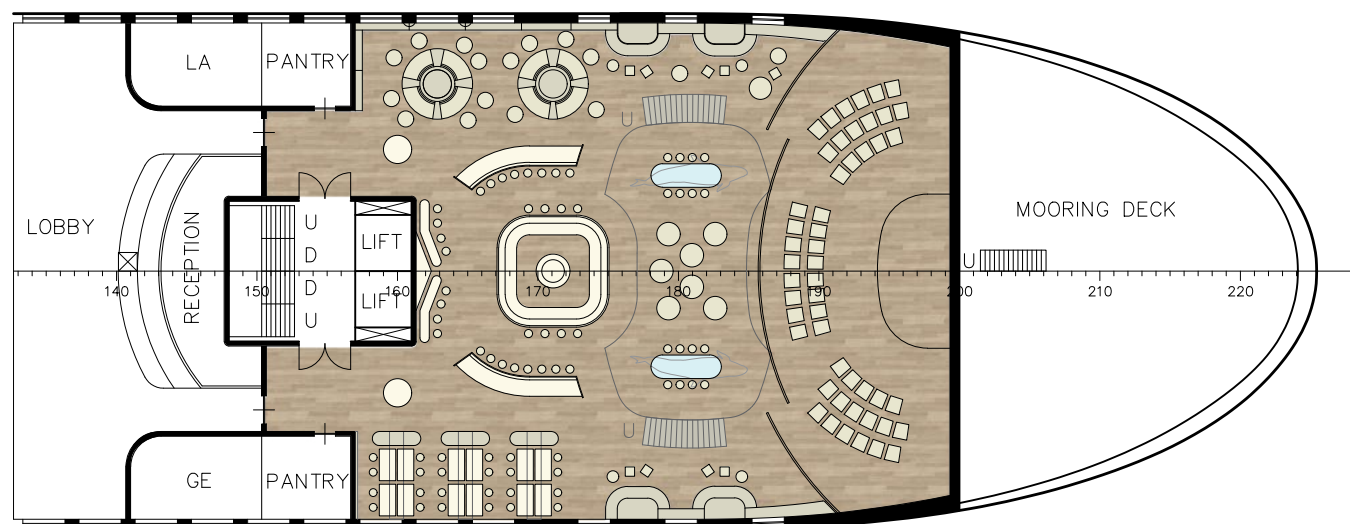
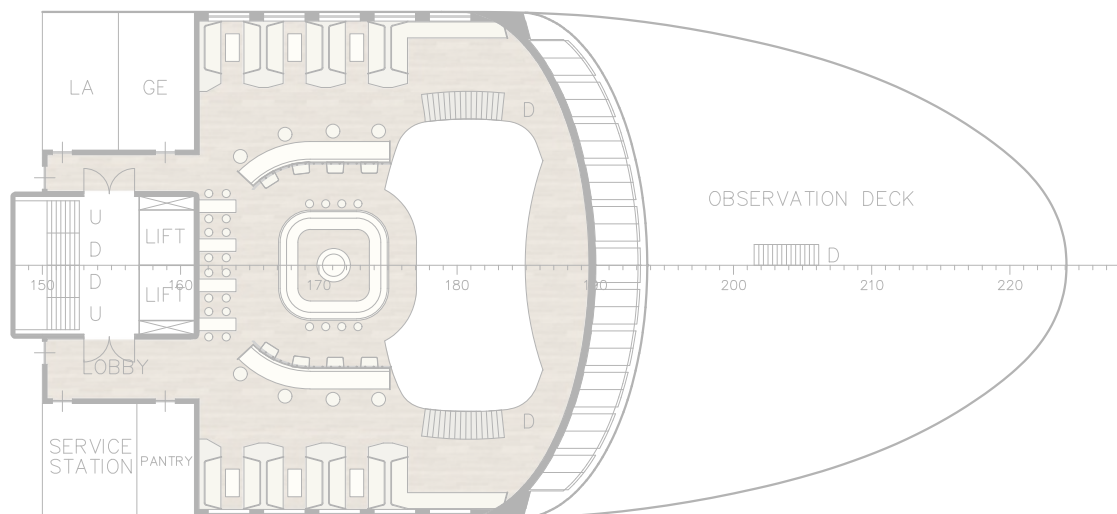

ARCTIC EXPEDITION

INTERIOR
 MULTI LOUNGE

DECK 5



ARCTIC EXPEDITION

INTERIOR

MULTI LOUNGE DECK 5 • EXHIBITION AREA AND VR

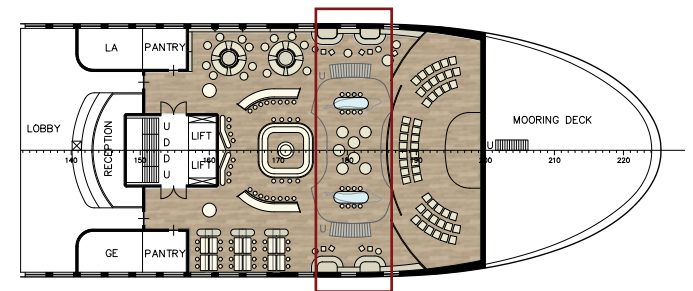



FOSSIL DISPLAY

VIRTUAL REALITY SQUARE

ARCTIC EXPEDITION

INTERIOR

MULTI LOUNGE DECK 5 • EXHIBITION AREA AND VR

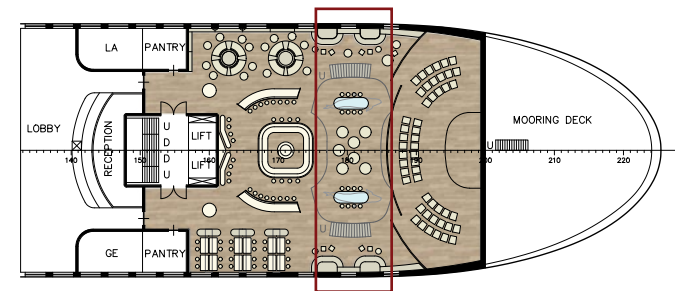



ARCTIC EXPEDITION

INTERIOR

MULTI LOUNGE DECK 5 • EXHIBITION AREA AND VR

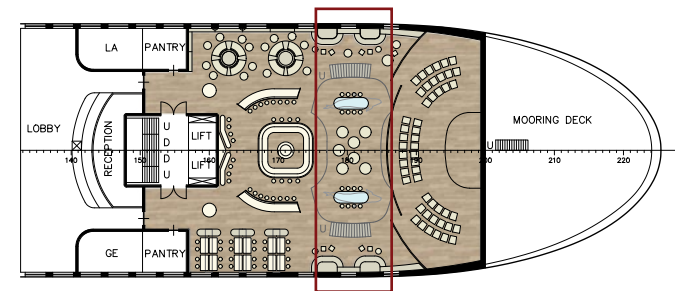



ARCTIC EXPEDITION

INTERIOR
MULTI LOUNGE DECK 5 • LIBRARY AREA

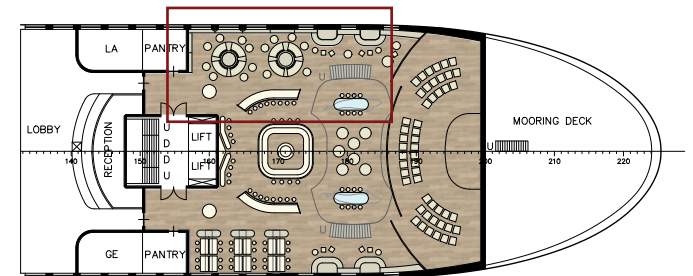



ARCTIC EXPEDITION

INTERIOR
MULTI LOUNGE DECK 5 • LIBRARY AREA

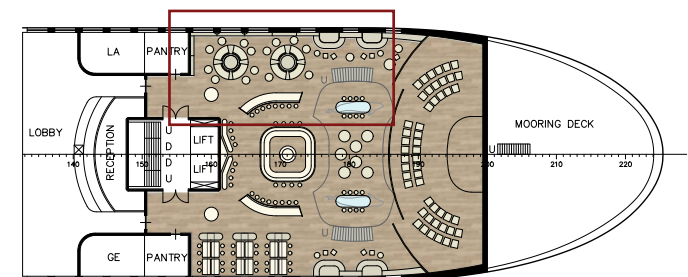



ARCTIC EXPEDITION

INTERIOR
MULTI LOUNGE DECK 5 • LIBRARY AREA

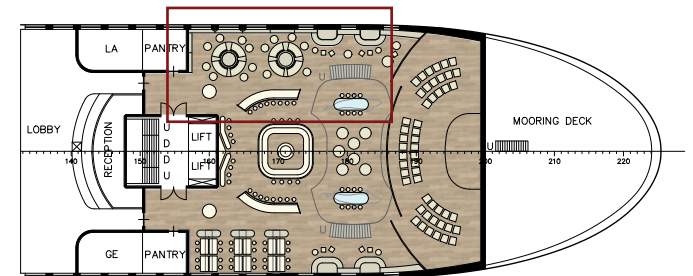



ARCTIC EXPEDITION

INTERIOR

MULTI LOUNGE DECK 5 • LIBRARY AREA

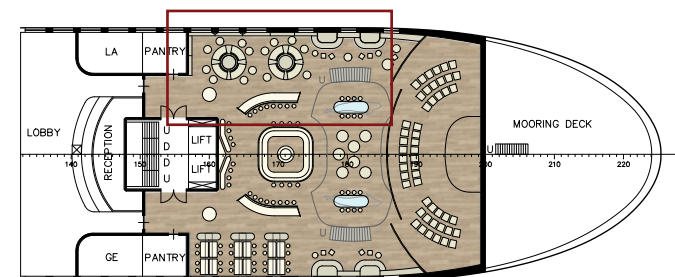



ARCTIC EXPEDITION

INTERIOR

MULTI LOUNGE DECK 5 • LIBRARY AREA

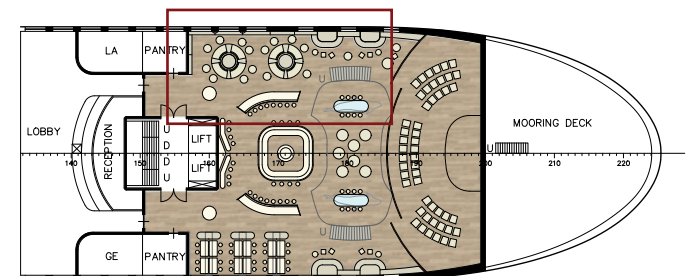



ARCTIC EXPEDITION

INTERIOR
MULTI LOUNGE DECK 5 • LIBRARY AREA

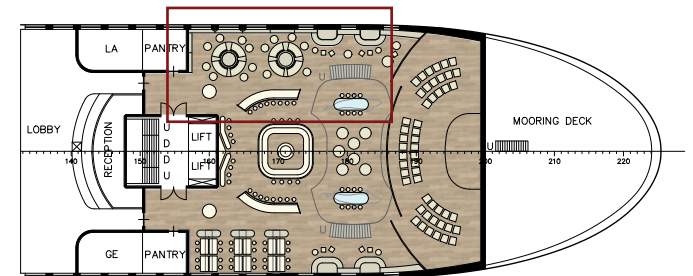



ARCTIC EXPEDITION

INTERIOR

MULTI LOUNGE DECK 5 • LIBRARY AREA

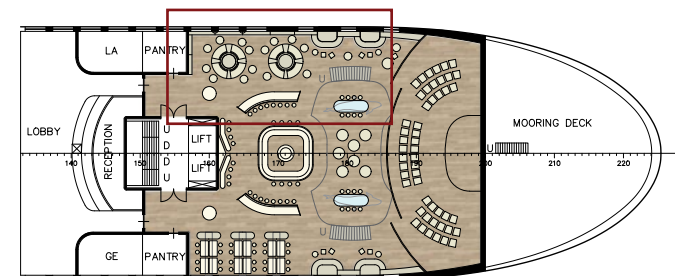



ARCTIC EXPEDITION

INTERIOR

MULTI LOUNGE DECK 5 • CENTRAL BAR

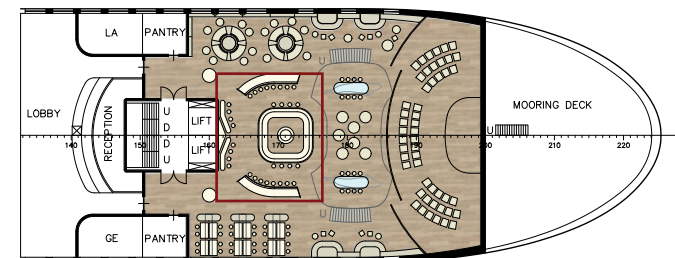



ARCTIC EXPEDITION

INTERIOR
MULTI LOUNGE DECK 5 • CENTRAL BAR

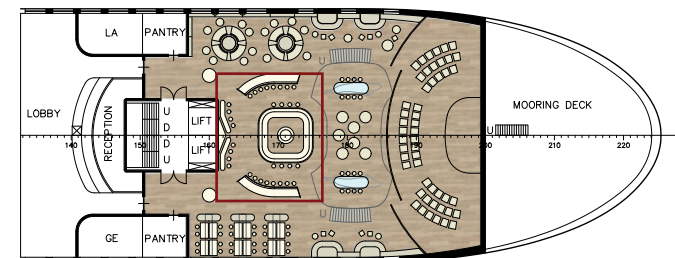



ARCTIC EXPEDITION

INTERIOR
MULTI LOUNGE DECK 5 • CENTRAL BAR

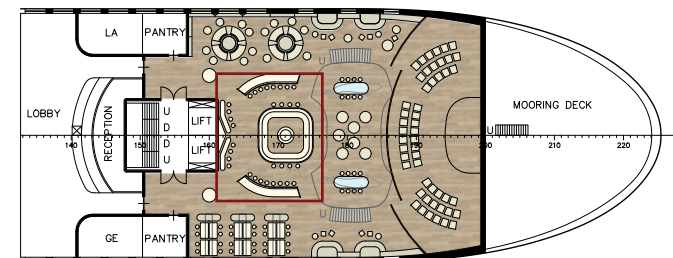



SIDE SEATING AREA WITH STOOLS

ARCTIC EXPEDITION

INTERIOR
MULTI LOUNGE DECK 5 • CENTRAL BAR

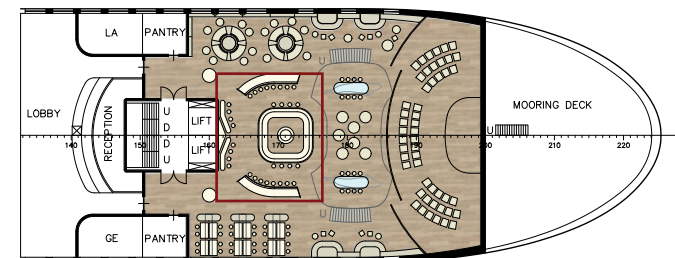



ARCTIC EXPEDITION

INTERIOR

MULTI LOUNGE DECK 5 • CENTRAL BAR

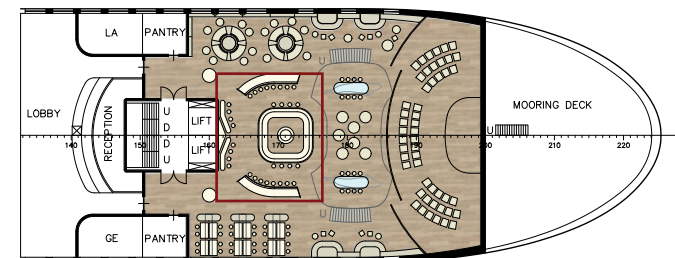



ARCTIC EXPEDITION

INTERIOR

MULTI LOUNGE DECK 5 • CENTRAL BAR

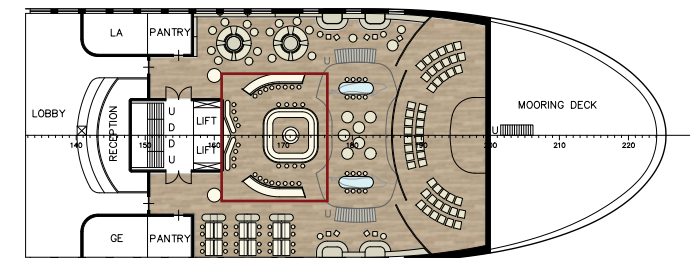



ARCTIC EXPEDITION

INTERIOR

MULTI LOUNGE DECK 5 • SCIENTIFIC LAB

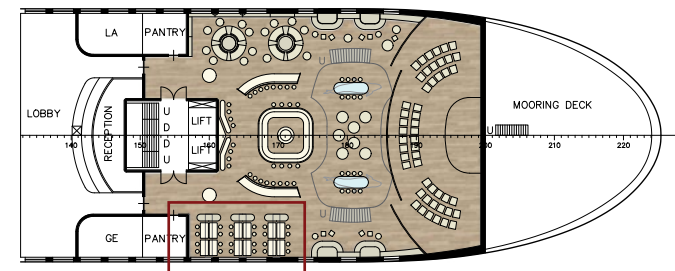



FOSSILS AND TOOLS DISPLAY

MICROSCOPE LAB

INTERACTIVE GLOBE

ARCTIC EXPEDITION

INTERIOR

MULTI LOUNGE DECK 5 • SCIENTIFIC LAB

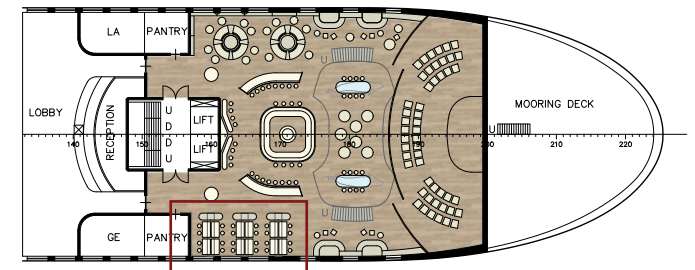



ARCTIC EXPEDITION

INTERIOR
MULTI LOUNGE DECK 5 • SCIENTIFIC LAB

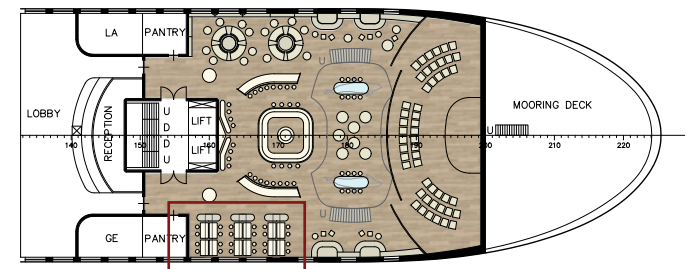



ARCTIC EXPEDITION

INTERIOR

MULTI LOUNGE DECK 5 • SCIENTIFIC LAB

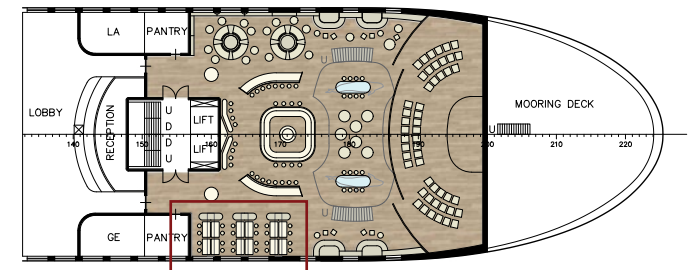



ARCTIC EXPEDITION

INTERIOR

MULTI LOUNGE DECK 5 ▪ LOUNGE AREA PS SB

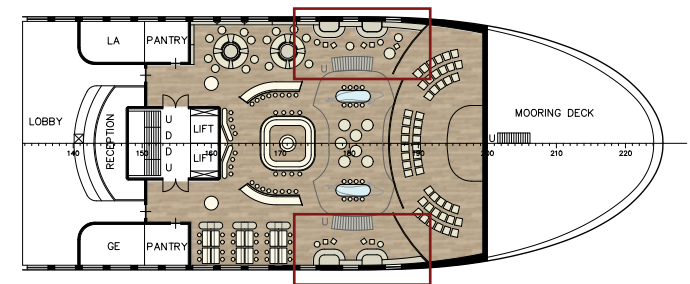

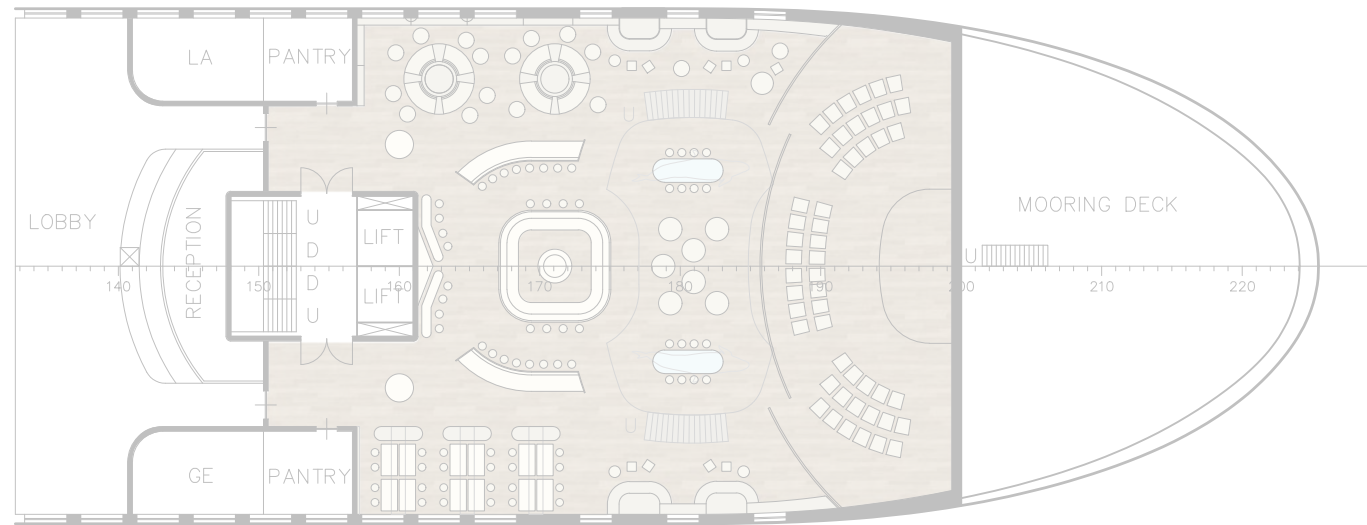
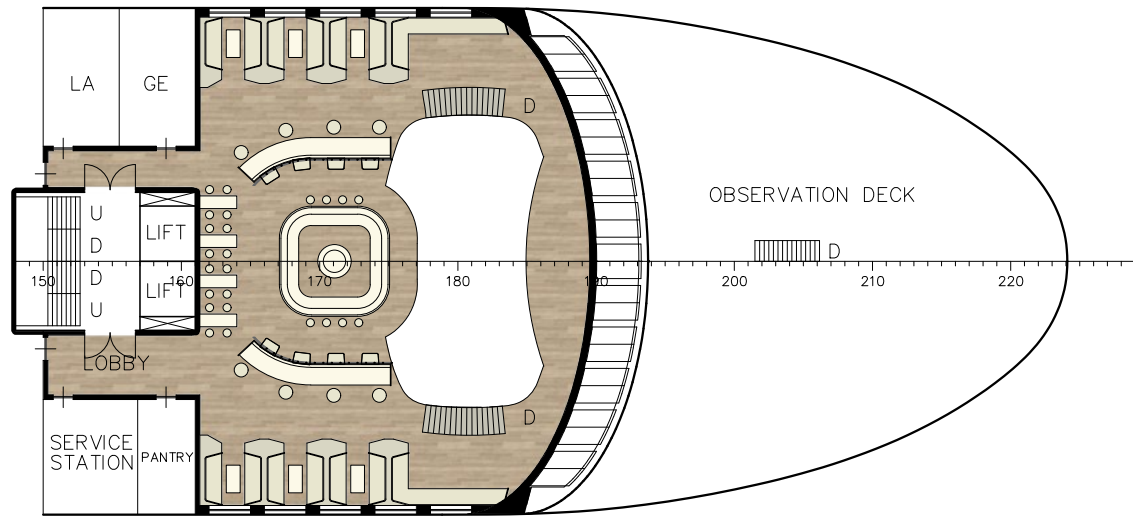

ARCTIC EXPEDITION

INTERIOR
LOUNGE

DECK 6



ARCTIC EXPEDITION

INTERIOR
MULTI LOUNGE DECK 5 & 6 ■ ATRIUM

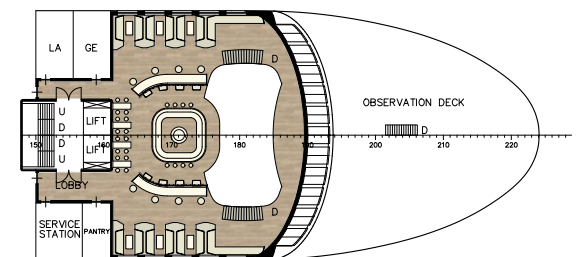



ARCTIC EXPEDITION

INTERIOR

MULTI LOUNGE DECK 5 & 6 ■ LOUNGE AREA

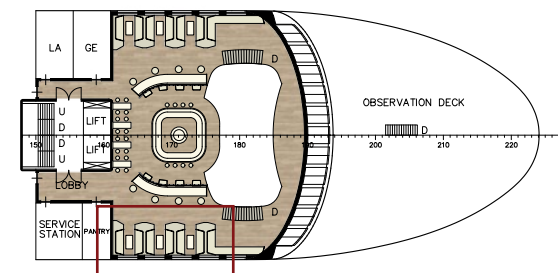

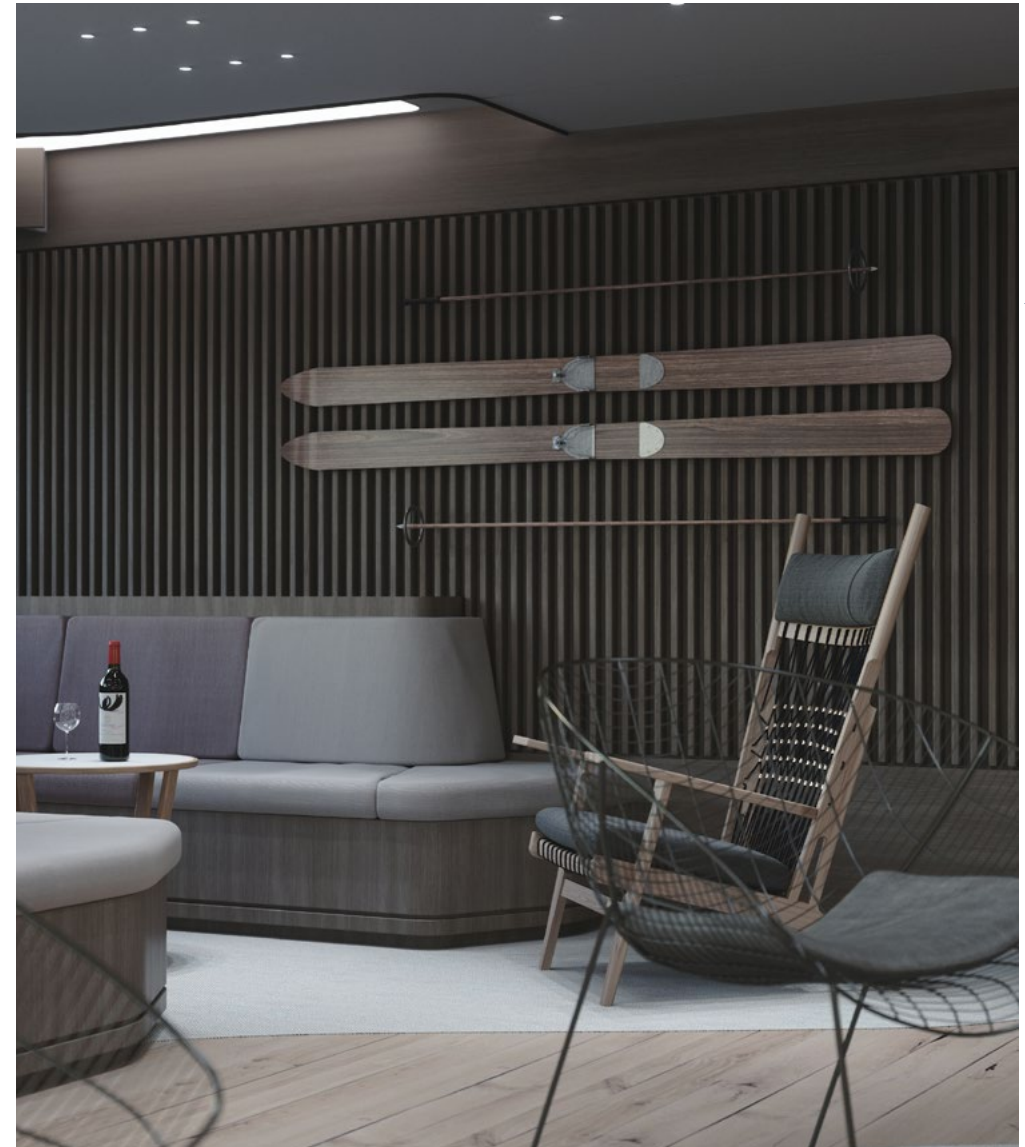

ARCTIC EXPEDITION

INTERIOR

MULTI LOUNGE DECK 5 ▪ LOUNGE AREA

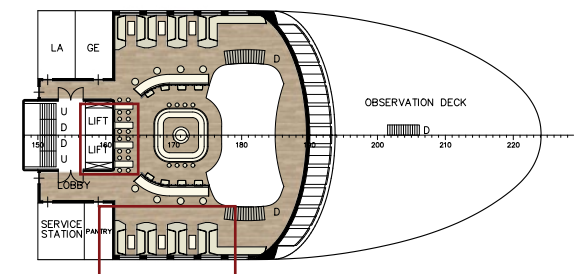



ARCTIC EXPEDITION

INTERIOR
MULTI LOUNGE DECK 5 & 6 ■ BAR

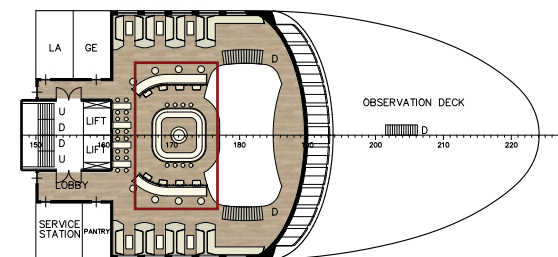



ARCTIC EXPEDITION

INTERIOR
MULTI LOUNGE DECK 5 & 6 ■ BAR

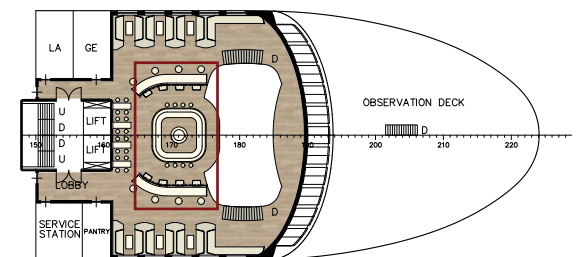



ARCTIC EXPEDITION

INTERIOR
MULTI LOUNGE DECK 5 & 6 ■ BAR

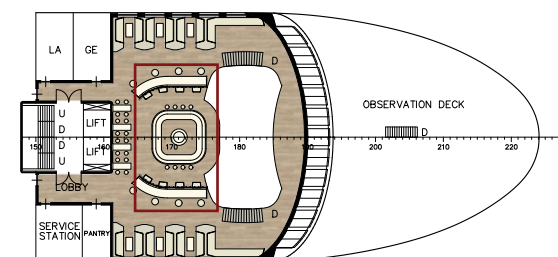



ARCTIC EXPEDITION

INTERIOR
MULTI LOUNGE DECK 5 & 6 • LOBBY

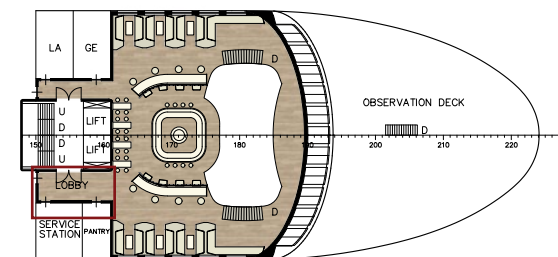



ARCTIC EXPEDITION

INTERIOR
MULTI LOUNGE DECK 5 & 6 ■ LOUNGE AREA FRONT

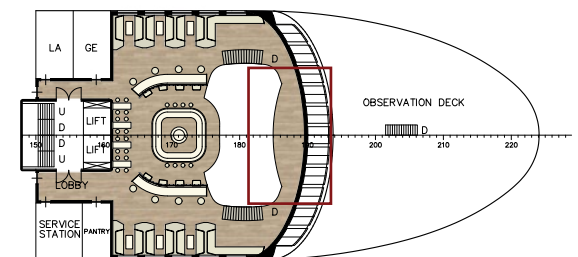



ARCTIC EXPEDITION

INTERIOR
MULTI LOUNGE DECK 5 & 6 ■ LOUNGE AREA FRONT

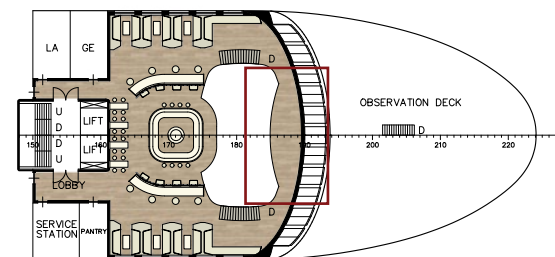



DENMARK

Main office

Lundegaarden, Claessensvej 1
3000 Elsinore
Denmark

Odense office

Kystvejen 100
5330 Munkebo
Denmark

AUSTRALIA

Suite 104
396 Scarborough Beach Road
Osborne Park 6017
Perth WA
Australia

CANADA

Suite # 381
160 – 3650 Hammonds Plains Road
Upper Tantallon, NS B3Z 4R3
Canada

FAROE ISLANDS

Vestara bryggja 15, 3 hædd
100 Tórshavn
Faroe Islands

GREECE

67, Akti Miaouli str.
18537 Piraeus
Greece

SPAIN

Algeciras 1, Planta 1^{ra},
Módulo 3-4
11011 Cádiz
Spain

UNITED KINGDOM

93 Great Suffolk Street
London, SE1 0BX
United Kingdom

USA

1650 S.E. 17th Street,
Suite 212
Fort Lauderdale, FL 33316
USA

WE DESIGN SHIPS We are a leading independent consultancy providing a comprehensive range of design, engineering and project management services to shipyards and ship owners around the world. Our innovative, customized solutions cover areas ranging from concept, tender/contract & basic design, to supporting the building and conversion process of all types of maritime vessels and offshore structures, to energy optimization and services for the offshore wind industry. **Since 1937, over 800 vessels have been built and over 400 conversions carried out to our designs.**

CONTACT

WWW.KNUDEHANSEN.COM

WE DESIGN SHIPS

